

# FOR BOARD-TO-CABLE CONNECTION

## 240 SERIES (GENERAL-PURPOSE TYPE)

### ■ FEATURES

- 1.27 mm (0.050 in.) pitch contact arrangement in two rows enables high-density mounting.
- Connectors with 20 to 96 contacts are available for various purposes.
- Discrete-wire (AWG #28, #30) I/O cables can be assembled by IDC. Metal covers completely protect sockets from EMI.
- Bellows contacts ensure stable contact preventing pins from bending. The bellows contacts also have excellent stability with repeated insertion and extraction.
- Tails are spaced in a four-row staggered arrangement (2.54 mm × 1.905 mm) (0.100 in. × 0.075 in.) for easy PC board design.
- Insulation is UL-approved (94V-0) and is washable.
- An FCN-230 EMI cover and dust cap can be used together.

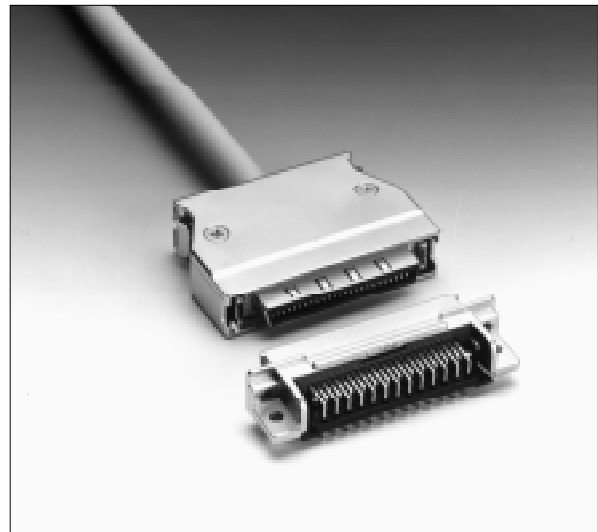

### ■ SPECIFICATIONS

| Item                         | Specifications  |
|------------------------------|---|
| Operating temperature range  | -55°C to +105°C   |
| Current rating               | DC 1 A  |
| Voltage rating               | AC 240 V  |
| Contact resistance           | 35 mΩ max. (DC 6 V, 0.1A)   |
| Insulation resistance        | 1000 MΩ min. (DC 500 V)   |
| Dielectric withstand voltage | AC 750 V for 1 minute   |
| Insertion force (kg)         | 4.5 kg max. (20 pins)   |
| Withdrawal force (kg)        | 0.6 kg min. (20 pins)   |
| Applicable PC board          | 1.6 mm (0.063 in.) thick  |
| Applicable wire (standard)   | IDC: AWG #28 and #30 stranded wires with $\phi$ 0.5 to 0.88 mm (0.020 to 0.035 in.) insulation diameter.<br>Soldering: AWG #26 max. (reference)<br>(The applicable wires depend on the number of contacts. See the descriptions of IDC sockets and metal covers.) |

### ■ MATERIALS

| Item      | Materials           |                   |
|-----------|---------------------|-------------------|
| Insulator | Polyester (UL94V-0) |                   |
| Conductor | Copper alloy        |                   |
| Plating   | Contact             | Gold plating      |
|           | Terminal            | Palladium plating |

# 240 Series (General-Purpose Type)

## STRAIGHT PLUG

### DIMENSIONS

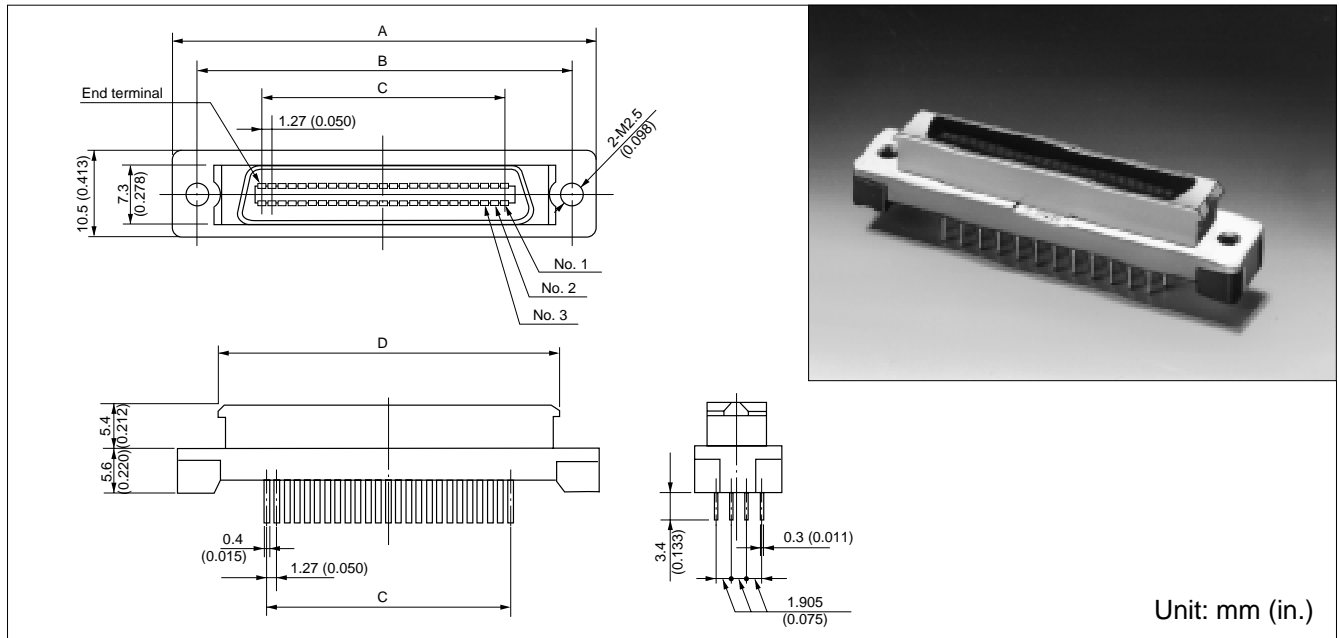

### MOUNTING HOLE LAYOUT

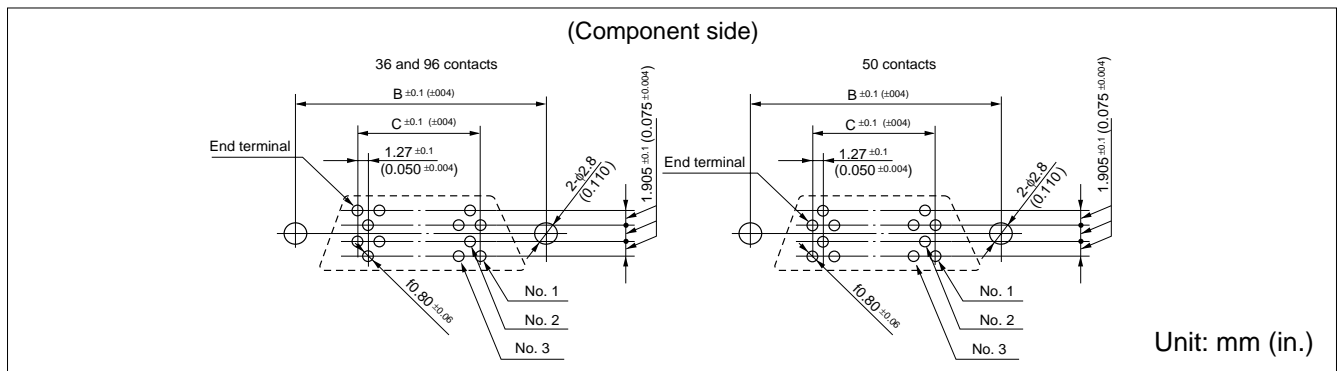

### RECOMMENDED PANEL DIMENSIONS

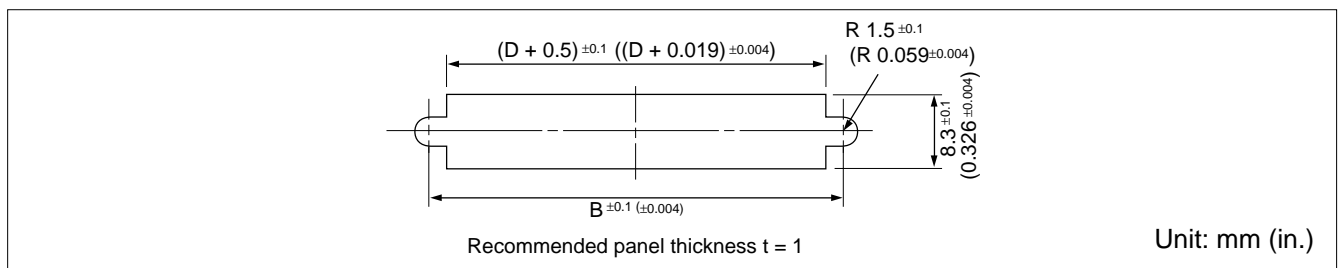

### PART NUMBERS AND DIMENSIONS

| Number of contacts | Part number     | Dimensions: mm (in.) |               |               |               |
|--------------------|-----------------|----------------------|---------------|---------------|---------------|
|                    |                 | A                    | B             | C             | D             |
| 36                 | FCN-244P036-G/E | 43.56 (1.714)        | 37.56 (1.478) | 21.59 (0.850) | 33.46 (1.317) |
| 50                 | FCN-244P050-G/E | 52.45 (2.064)        | 46.45 (1.828) | 30.48 (1.200) | 42.35 (1.607) |
| 96                 | FCN-244P096-G/E | 81.66 (3.214)        | 75.66 (2.978) | 59.69 (2.350) | 71.56 (2.817) |

# 240 Series (General-Purpose Type)

## Fujitsu Components International Headquarter Offices

### Japan

Fujitsu Component Limited  
Gotanda-Chuo Building  
3-5, Higashigotanda 2-chome, Shinagawa-ku  
Tokyo 141, Japan  
Tel: (81-3) 5449-7010  
Fax: (81-3) 5449-2626  
Email: [promothq@ft.ed.fujitsu.com](mailto:promothq@ft.ed.fujitsu.com)  
Web: [www.fcl.fujitsu.com](http://www.fcl.fujitsu.com)

### North and South America

Fujitsu Components America, Inc.  
250 E. Caribbean Drive  
Sunnyvale, CA 94089 U.S.A.  
Tel: (1-408) 745-4900  
Fax: (1-408) 745-4970  
Email: [marcom@fcai.fujitsu.com](mailto:marcom@fcai.fujitsu.com)  
Web: [www.fcai.fujitsu.com](http://www.fcai.fujitsu.com)

### Europe

Fujitsu Components Europe B.V.  
Diamantlaan 25  
2132 WV Hoofddorp  
Netherlands  
Tel: (31-23) 5560910  
Fax: (31-23) 5560950  
Email: [info.marketing@fceu.fujitsu.com](mailto:info.marketing@fceu.fujitsu.com)  
Web: [www.fceu.fujitsu.com](http://www.fceu.fujitsu.com)

### Asia Pacific

Fujitsu Components Asia Ltd.  
102E Pasir Panjang Road  
#04-01 Citilink Warehouse Complex  
Singapore 118529  
Tel: (65) 375-8560  
Fax: (65) 273-3021  
Email: [fcal@fcal.fujitsu.com](mailto:fcal@fcal.fujitsu.com)  
[www.fcal.fujitsu.com](http://www.fcal.fujitsu.com)

© 2001 Fujitsu Components America, Inc. All company and product names are trademarks or registered trademarks of their respective owners. Rev. 09/2001